

Cardinal

SHOWER ENCLOSURES

Cardinal Series Continuous Hinge Shower Enclosure

Installation Instructions

Model **CRFD DOOR - I-C-PACK**

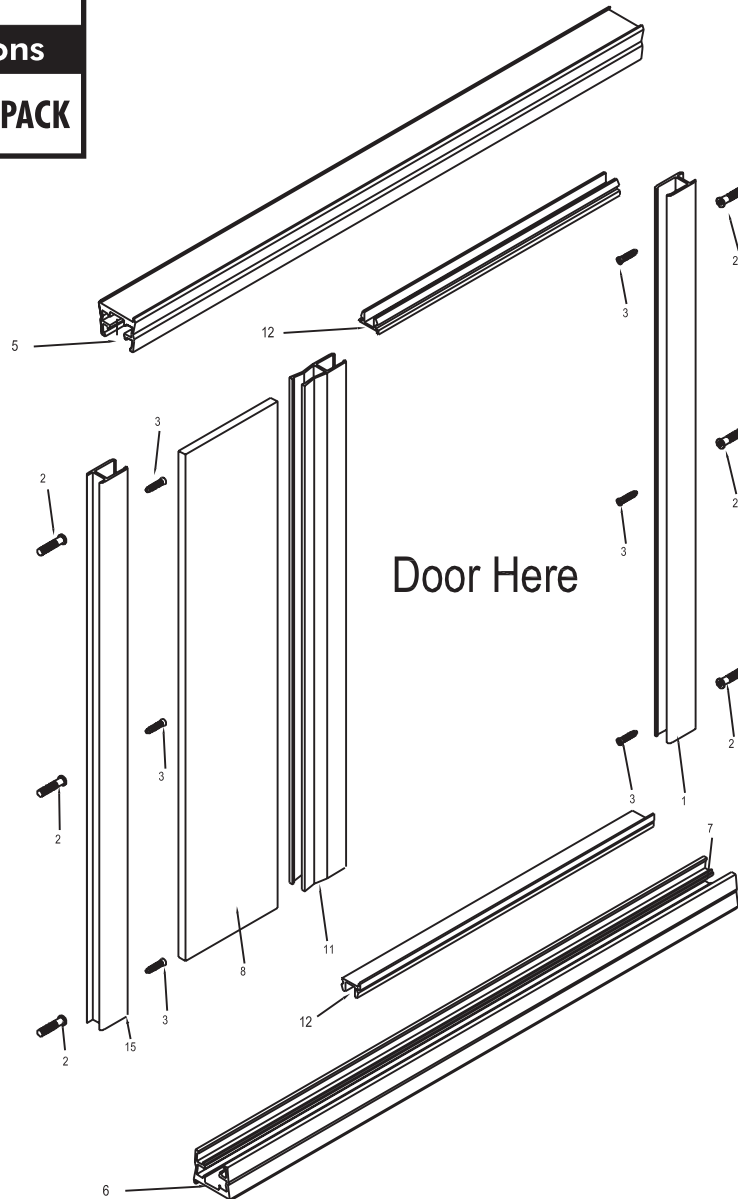

SHOWER ENCLOSURES I-C-Pack

When ordering repair parts, please give the following information:

1. Model Number
2. Part Number
3. Part Description
4. Color

To install your shower enclosure, you will need the following:

- Level
- #31 Drill Bit
- Glazing Block
- Hack Saw
- 3/16" Carbide Drill Bit (for the tile walls)
- Phillips Screwdriver
- Silicone

*Note: Numbers 1, 2 & 3 come with door stall wrap

Description	Qty	Part No.	Picture
1. Wall Channels*	2	ZD-1006	
2. Wall Anchors*	6	ZV-935	
3. #8 x 1 1/4" Screws*	6	#8 x 1 1/4"	
4. #6 x 3/8" Screws	8	#6 X 3/8"	
5. Headers	1	ZSS-3101	
6. Curbs	1	ZSS-3101	
7. Glass Support Blocks	1	ZV-902	
8. In-Line Glass Panel	1		
9. Vertical Seal Vinyl	4	ZV-909	
10. Horizontal Seal Vinyl	4	ZV-906	
11. In-Line Post	1	ZSS-1103	
12. Header and Curb Fillers	2	ZSS-1102	